

9010 Excavator Service Manual

Table of Contents

Description	Section No.	Form No.
General Tab 1		
Section Index - General		7-45730
Standard Torque Specifications for 9000 Series Excavators	1001	7-44790
Fluids and Lubricants	1002	7-45590
Engines Tab 2		
Section Index - Engines		7-45740
Engine Removal and Installation	2001	7-46680
Radiator Removal and Installation	2002	7-46690
Engine Specification Details	2402	8-24163
Cylinder Head and Valve Train	2415	8-24173
Cylinder Block	2425	8-24183
Lubrication	2445	8-24193
Cooling System	2455	8-24203
Turbocharger	2465	8-25550
Turbocharger Failure Analysis	2565	9-78235
Fuel System Tab 3		
Section Index - Fuel System		7-45750
Fuel System and Filters	3410	8-24212
Fuel Injectors	3413	8-24233
Fuel Injection Pump (Bosch)	3415	7-37141
Electrical Tab 4		
Section Index - Electrical		7-45760
Electrical Specifications and Troubleshooting	4001	7-45690
Electric Schematic Foldout	In Rear Pocket	7-45710
Batteries	4002	7-44950
Systems Display Panel	4005	7-44980
Starter and Starter Solenoid	4006	8-42191
Alternator	4009	8-16570
Tracks Tab 5		
Section Index - Tracks		7-45800
Troubleshooting the Track System	5001	7-44830
Tracks, Rollers, and Idlers	5002	7-45810
Power Train Tab 6		
Section Index - Power Train		7-45820
Troubleshooting - See Section 8001		
Drive Motor and Final Drive Transmission	6000	7-45830

Reprinted

9010 Excavator Service Manual Table of Contents

Description	Section No.	Form No.
Hydraulics		Tab 8
Section Index - Hydraulics		7-45840
Cleaning the Hydraulic System	8000	7-45050
Hydraulic Specifications, Troubleshooting, and Pressure Checks	8001	7-45700
Hydraulic Schematic Foldout	In Rear Pocket	7-45710
Main Hydraulic Pump	8002	7-45860
Pilot Control Circuit Pump	8003	7-45870
Hydraulic Swivel	8004	7-45880
Main Control Valve	8005	7-45890
Remote Control Valves	8006	7-45900
Solenoid Valves	8007	7-45910
Swing Motor and Swing Reduction Gear Box	8008	7-45920
Cylinders	8009	7-45930
Cushion Control Valve	8010	7-46850
Boom Holding Valve	8011	7-46760
Auxiliary Control Valve	8012	7-46770
Mounted Equipment		Tab 9
Section Index - Mounted Equipment		7-45940
Pedals and Levers	9001	7-45660
Turntable Bearing	9003	7-46740
Boom and Arm	9004	7-45960
Seat and Seat Belts	9006	7-45170
Electric and Hydraulic Schematic Foldout	In Rear Pocket	7-45710

SECTION INDEX - GENERAL

Section Title	Section Number
Standard Torque Specifications for 9000 Series Excavators	1001
Fluids and Lubricants	1002

<https://caseihservicemanual.com/>

Click on the image link below for the full version of the service manual



Section 1001

STANDARD TORQUE SPECIFICATIONS FOR 9000 SERIES EXCAVATORS



Bur 7-44790

Copyright © 1992 CASE CORPORATION
Printed in U.S.A.
Issued November 1992

TABLE OF CONTENTS

TORQUE SPECIFICATIONS - DECIMAL HARDWARE2

TORQUE SPECIFICATIONS - METRIC HARDWARE3

TORQUE SPECIFICATIONS - STEEL HYDRAULIC FITTINGS4

TORQUE SPECIFICATIONS - O-RING FACE SEAL FITTINGS5

TORQUE SPECIFICATIONS - DECIMAL HARDWARE

Use the torques in this chart when special torques are not given. These torques apply to fasteners with both UNC and UNF threads as received from suppliers, dry, or when lubricated with engine oil. Not applicable if special graphites, molydisulfide greases, or other extreme pressure lubricants are used.

Grade 5 Bolts, Nuts, and Studs		
		
Size	Pound-Feet	Newton metres
1/4 in	9-11	12-15
5/16 in	17-21	23-28
3/8 in	35-42	48-57
7/16 in	54-64	73-87
1/2 in	80-96	109-130
9/16 in	110-132	149-179
5/8 in	150-180	203-244
3/4 in	270-324	366-439
7/8 in	400-480	542-651
1.0 in	580-696	787-944
1-1/8 in	800-880	1085-1193
1-1/4 in	1120-1240	1519-1681
1-3/8 in	1460-1680	1980-2278
1-1/2 in	1940-2200	2631-2983

Grade 8 Bolts, Nuts, and Studs		
		
Size	Pound-Feet	Newton metres
1/4 in	12-15	16-20
5/16 in	24-29	33-39
3/8 in	45-54	61-73
7/16 in	70-84	95-114
1/2 in	110-132	149-179
9/16 in	160-192	217-260
5/8 in	220-264	298-358
3/4 in	380-456	515-618
7/8 in	600-720	814-976
1.0 in	900-1080	1220-1465
1-1/8 in	1280-1440	1736-1953
1-1/4 in	1820-2000	2468-2712
1-3/8 in	2380-2720	3227-3688
1-1/2 in	3160-3560	4285-4827

NOTE: Use thick nuts with Grade 8 bolts.

TORQUE SPECIFICATIONS - METRIC HARDWARE

Use the following torques when specifications are not given.

These values apply to fasteners with coarse threads as received from supplier, plated or unplated, or when lubricated with engine oil. These values do not apply if graphite or molydisulfide grease or oil is used.

Grade 8.8 Bolts, Nuts, and Studs		
		
Size	Pound-Feet	Newton metres
M6	6-7	8-9
M8	14-17	20-23
M10	29-34	39-46
M12	50-59	68-80
M16	128-149	173-202
M20	249-291	337-393
M22	342-399	464-541
M24	431-503	584-681
M27	637-743	864-1008
M30	863-1007	1170-1365
M33	1180-1377	1600-1867
M36	1977-2307	2680-3127
M42	2434-2840	3300-3850
M45	3054-3563	4140-4830
M48	3658-4268	4960-5787
M52	4757-5549	6450-7525
M56	5908-6893	8010-9345
M64	8925-10413	12100-14117

Grade 10.9 Bolts, Nuts, and Studs		
		
Size	Pound-Feet	Newton metres
M6	8-10	11-13
M8	20-24	28-32
M10	41-47	55-64
M12	71-83	96-112
M16	178-208	242-282
M20	350-408	475-554
M22	481-561	652-761
M24	606-707	821-958
M27	900-1050	1220-1423
M30	1217-1420	1650-1925
M33	1667-1945	2260-2637
M36	2124-2478	2880-3360
M39	2773-3235	3760-4387
M42	3422-3992	4640-5413
M45	4293-5009	5820-6790
M48	5141-5998	6970-8132
M52	6690-7805	9070-10582
M56	8334-9723	11300-13183
M64	12612-14714	17100-19950

Grade 12.9 Bolts, Nuts, and Studs



Usually the torque values specified for grade 10.9 fasteners can be used satisfactorily on grade 12.9 fasteners.

TORQUE SPECIFICATIONS - STEEL HYDRAULIC FITTINGS

Tube OD Hose ID	Thread Size	Pound- Feet	Newton metres
37 Degree Flare Fittings			
1/4 in 6.4 mm	7/16-20	6-12	8-16
5/16 in 7.9 mm	1/2-20	8-16	11-22
3/8 in 9.5 mm	9/16-18	10-25	14-34
1/2 in 12.7 mm	3/4-16	15-42	20-57
5/8 in 15.9 mm	7/8-14	25-58	34-79
3/4 in 19.0 mm	1-1/16-12	40-80	54-108
7/8 in 22.2 mm	1-3/16-12	60-100	81-135
1.0 in 25.4 mm	1-5/16-12	75-117	102-158
1-1/4 in 31.8 mm	1-5/8-12	125-165	169-223
1-1/2 in 38.1 mm	1-7/8-12	210-250	285-338

Tube OD Hose ID	Thread Size	Pound- Feet	Newton metres
Straight Threads with O-ring			
1/4 in 6.4 mm	7/16-20	12-19	16-26
5/16 in 7.9 mm	1/2-20	16-25	22-34
3/8 in 9.5 mm	9/16-18	25-40	34-54
1/2 in 12.7 mm	3/4-16	42-67	57-91
5/8 in 15.9 mm	7/8-14	58-92	79-124
3/4 in 19.0 mm	1-1/16-12	80-128	108-174
7/8 in 22.2 mm	1-3/16-12	100-160	136-216
1.0 in 25.4 mm	1-5/16-12	117-187	159-253
1-1/4 in 31.8 mm	1-5/8-12	165-264	224-357
1-1/2 in 38.1 mm	1-7/8-12	250-400	339-542

Split Flange Mounting Bolts*		
Size	Pound- Feet	Newton metres
5/16-18	15-20	20-27
3/8-16	20-25	27-34
7/16-14	35-45	47-61
1/2-13	55-65	74-88
5/8-11	140-150	190-203

**NOTE: Use standard metric hardware torque for metric split flange mounting bolts.*

TORQUE SPECIFICATIONS - O-RING FACE SEAL FITTINGS

Nom. SAE Dash Size	Tube OD	Thread Size	Pound-Feet	Newton metres	Thread Size	Pound-Feet	Newton metres
O-ring Face Seal End					O-ring Boss End Fitting or Lock Nut		
-4	1/4 in 6.4 mm	9/16-18	10-12	14-16	7/16-20	17-20	23-27
-6	3/8 in 9.5 mm	11/16-16	18-20	24-27	9/16-18	25-30	34-41
-8	1/2 in 12.7 mm	13/16-16	32-40	43-54	3/4-16	45-50	61-68
-10	5/8 in 15.9 mm	1-14	46-56	62-76	7/8-14	60-65	81-88
-12	3/4 in 19.0 mm	1-3/16-12	65-80	90-110	1-1/16-12	85-90	115-122
-14	7/8 in 22.2 mm	1-3/16-12	65-80	90-110	1-3/16-12	95-100	129-136
-16	1.0 in 25.4 mm	1-7/16-12	92-105	125-140	1-5/16-12	115-125	156-169
-20	1-1/4 in 31.8 mm	1-11/16-12	125-140	170-190	1-5/8-12	150-160	203-217
-24	1-1/2 in 38.1 mm	2-12	150-180	200-254	1-7/8-12	190-200	258-271

Section 1002

1002

FLUIDS AND LUBRICANTS



Bur 7-45590

Copyright 1993 Case Corporation
Printed in U.S.A.
Issued February 1993

TABLE OF CONTENTS

CAPACITIES AND LUBRICANT SPECIFICATIONS	3
HYDRAULIC OIL CHART	4
ENGINE LUBRICATION	5
Engine Oil Selection	5
Oil Viscosity/Temperature Ranges	5
DIESEL FUEL	6
Fuel Storage	6

NOTE: The J I Case Company reserves the right to make improvements in design or changes in specifications at any time without incurring any obligation to install them on units previously sold.

CAPACITIES AND LUBRICANT SPECIFICATIONS

Fuel Tank	
Capacity	63.4 U.S. gallons (240 litres)
Type of fuel	See Diesel Fuel on page 6
Engine Oil Capacity	
Capacity with filter change	11.6 U.S. quarts (11 litres)
Type of Lubricant	Case IH Engine Oil, see Engine Lubrication on page 5
Engine Cooling System	
Capacity	5 U.S. gallons (18.9 litres)
Type of coolant	Use a mixture of 55% ethylene glycol and 45% water.
If lowest ambient temperature will be below -34°F (1.11°C) adjust the mixture.	
Hydraulic Reservoir	
Tank capacity	21.9 U.S. gallons (83 litres)
System capacity	41.4 U.S. gallons (157 litres)
Type of fluid	See Hydraulic Oil Chart on page 4
Swing Gearbox	
Capacity	1.8 U.S. quarts (1.7 litres)
Type of lubricant	Case IH 135H EP Gear Lube
Swing Ring Gear	
Capacity	22 pounds (10 kg)
Type of lubricant	Case No. 2 Lithium Grease
Turntable Bearing	
Capacity	As required
Type of lubricant	Case No. 2 Lithium Grease
Final Drives	
Capacity	2.8 U.S. quarts (2.5 litres)
Type of lubricant	Case IH 135H EP Gear Lube
Track Roller	
Capacity	5.3 ounces (160 cc)
Type of lubricant	Shell Rimula Oil No. 30 or equivalent to API Class CD, SAE 30
Carrier Roller	
Capacity	3.6 ounces (110 cc)
Type of lubricant	Shell Rimula Oil No. 30 or equivalent to API Class CD, SAE 30
Idler Wheel	
Capacity	4.6 ounces (140 cc)
Type of lubricant	Shell Rimula Oil No. 30 or equivalent to API Class CD, SAE 30
Track Adjustment Cylinder	
Capacity	As required
Type of lubricant	Case No. 2 Lithium Grease
Grease Fitting	
Type of lubricant	Case No. 2 Lithium Grease
Batteries	
Capacity	As required
Type of lubricant	Use drinking or distilled water

HYDRAULIC OIL CHART

Use only hydraulic oils meeting Case specifications of equivalent AW (anti-wear) hydraulic oils.

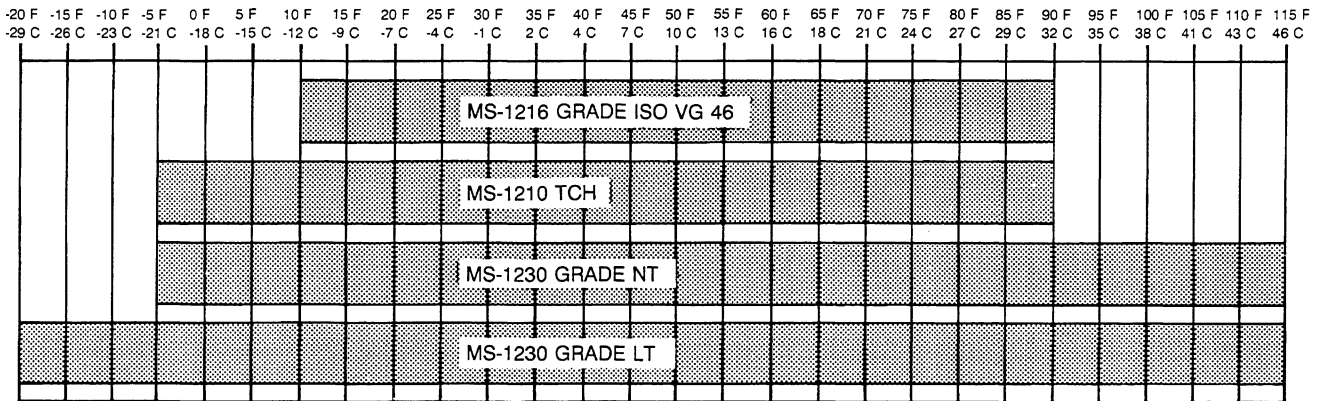

B922640J

NOTE: Case specification MS-1210 TCH Fluid is used in place of ISO VG 32 (-5° to +65°F) and ISO VG 46 (+10° to +90°F).

Case specifications MS-1230 Grade NT or Grade LT is used in place of ISO VG 32 (-5° to +65°F), ISO VG 46 (+10° to +90°F), ISO VG 100 (+30° to 115°F), and MS-1210 TCH.

ENGINE LUBRICATION

Engine Oil Selection

Case No. 1 Engine Oil is recommended for use in your Case Engine. Case Engine Oil will lubricate your engine correctly under all operating conditions.



A2688

If Case No. 1 Multi-Viscosity or Single Grade Engine Oil is not available, use only oil meeting API engine oil service category CE.



654L9

NOTE: Do not put Performance Additives or other oil additive products in the engine crankcase. The oil change intervals given in this manual are according to tests with Case lubricants.

Oil Viscosity/Temperature Ranges

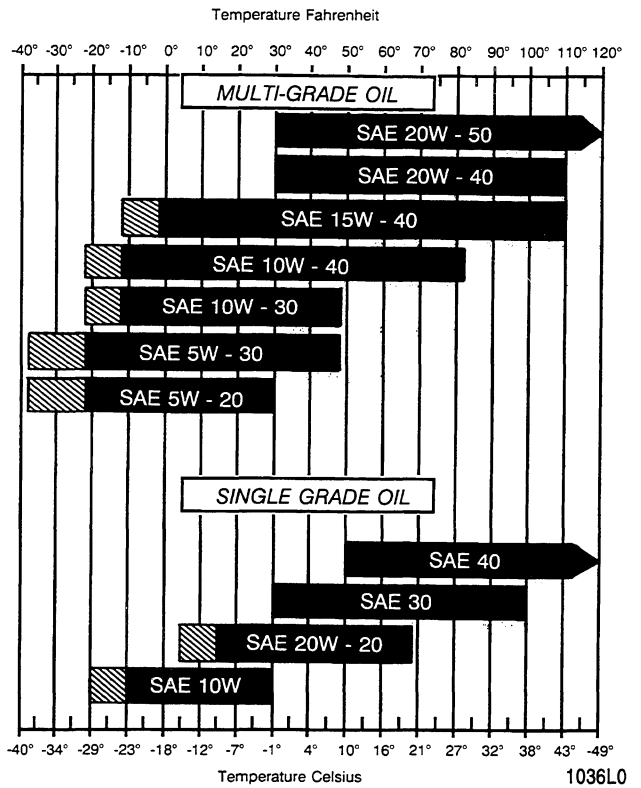

NOTE: Use of an engine oil pan heater or an engine coolant heater is required when operating temperatures are in the crosshatched area.

DIESEL FUEL

Use No. 2 diesel fuel in the engine of this machine. The use of other fuels can cause the loss of engine power and high fuel consumption.

In very cold temperatures, a mixture of No. 1 and No. 2 diesel fuels is temporarily permitted. See the following Note.

NOTE: See your fuel dealer for winter fuel requirements in your area. If the temperature of the fuel lowers below the cloud point (wax appearance point), wax crystals in the fuel will cause the engine to lose power or not start.

The diesel fuel in this machine must meet the specifications in the chart below or Specification D975-81 of the American Society for Testing and Materials.

Specifications for Acceptable No. 2 Diesel Fuel

API gravity, minimum	34
Flash point, minimum	140°F (60°C)
Cloud point (wax appearance point), maximum	-5°F (-20°C) See Note above
Pour point, maximum	-15°F (-26°C) See Note above
Distillation temperature, 90% point	540 to 640°F (282 to 338°C)
Viscosity, at 100°F (38°C)	
Centistokes	2.0 to 4.3
Saybolt Seconds Universal	32 to 40
Cetane number, minimum	43 (45 to 55 for winter or high altitudes)
Water and sediment, by volume, maximum	0.05 of 1%
Sulfur, by weight, maximum	0.50 of 1%
Copper strip corrosion, maximum	No. 2
Ash, by weight, maximum	0.01 of 1%

Fuel Storage

If you keep fuel in storage for a period of time, you can get foreign material or water in the fuel storage tank. Many engine problems are caused by water in the fuel.

Keep the fuel storage tank outside and keep the fuel as cool as possible. Remove water from the storage container at regular periods of time.

Fill the fuel tank at the end of the daily operating period to prevent condensation in the fuel tank.



Engine fuel is flammable and can cause a fire or an explosion. Do not fill the fuel tank or service the fuel system near an open flame, welding, burning cigars, cigarettes, etc.

SECTION INDEX - ENGINES

Section Title	Section Number
Engine Removal and Installation	2001
Radiator Removal and Installation	2002
Engine Specification Details.....	2402
Cylinder Head and Valve Train	2415
Cylinder Block	2425
Lubrication	2445
Cooling System	2455
Turbocharger	2465
Turbocharger Failure Analysis	2565

Section 2001

ENGINE REMOVAL AND INSTALLATION

TABLE OF CONTENTS

SPECIFICATIONS	3
SPECIAL TOOLS	3
ENGINE	4
Removal	4
Installation	8

NOTE: The J I Case Company reserves the right to make improvements in design or changes in specifications at any time without incurring any obligation to install them on units previously sold.

SPECIFICATIONS

Cooling system capacity 5 U.S. gallons (18.9 litres)

Special torques

Bolts that hold the engine mounts to the frame 195 to 231 pound-feet (264 to 313 Nm)

Cap screws that hold the rear engine mounts to the engine 71 to 83 pound-feet (96 to 112 Nm)

Cap screws that hold the front engine mounts to the engine 71 to 83 pound-feet (96 to 112 Nm)

Cap screws that hold the fan and the spacer to the engine 38 to 45 pound-feet (51 to 61 Nm)

Cap screws that hold the hydraulic pump to the flywheel housing 48 to 56 pound-feet (65 to 76 Nm)

Weight of the hydraulic pump 201 pounds (91 kg)

Weight of the engine 772 pounds (350 kg)

SPECIAL TOOLS

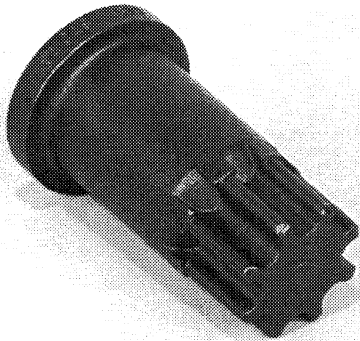

B430842M

CAS-1690 Tool used to rotate the flywheel.

ENGINE

Removal

1. Park the machine on a hard level surface. Lower the tool to the floor and stop the engine.

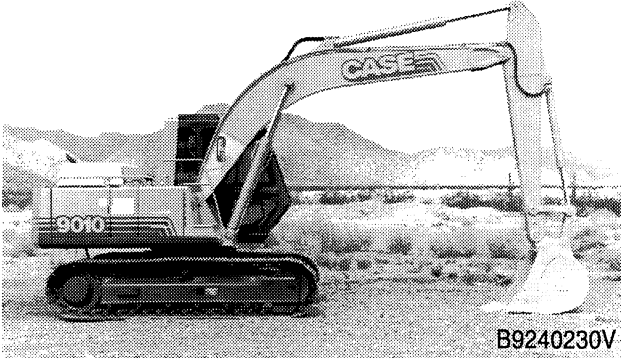

2. Open the access doors over the engine and on each side of the engine compartment. Remove the access covers from under the engine and the radiator.

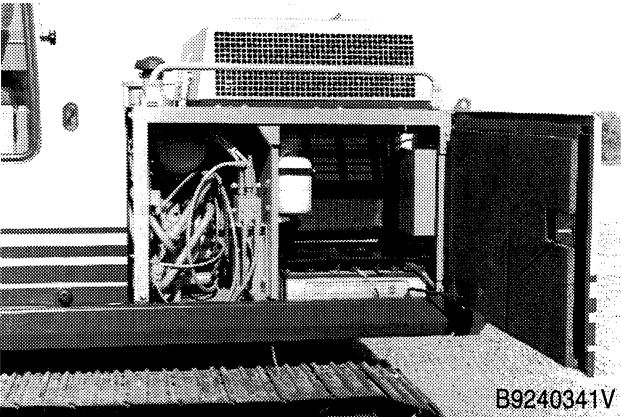

3. Make sure that the engine is cool and remove the radiator cap. Open the drain valve and drain the cooling system. The cooling system holds 5 U.S. gallons (18.9 litres) of coolant.

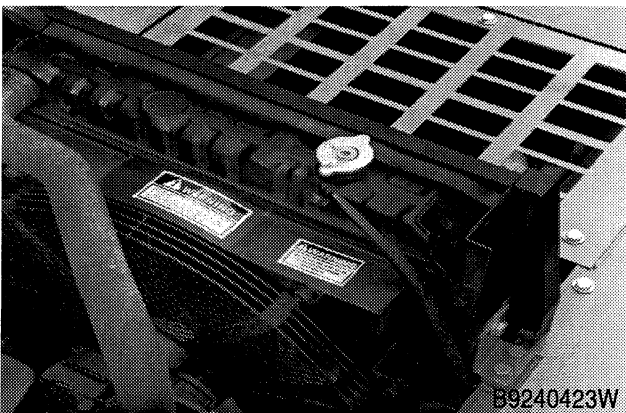

4. Remove the access cover for the batteries and disconnect the ground cable.

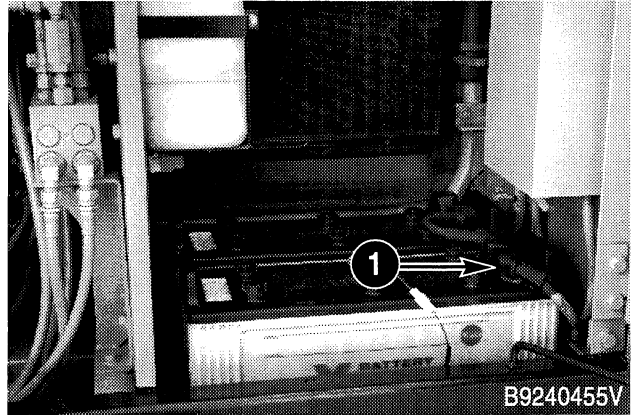

1. Ground Cable

5. Remove the muffler and the mounting bracket for the muffler.

6. Disconnect the hose for the air cleaner from the turbocharger.

7. Disconnect the top (3) and bottom (4) radiator hoses from the radiator.

8. Disconnect the hose (2) for the coolant reservoir from the radiator.

9. Remove the fan guard and the fan shroud from the radiator.

10. Remove the cap screws and hardware that hold the fan and the spacer to the engine.

11. Disconnect the fuel supply hose and the fuel return hose. Install a plug in each hose.

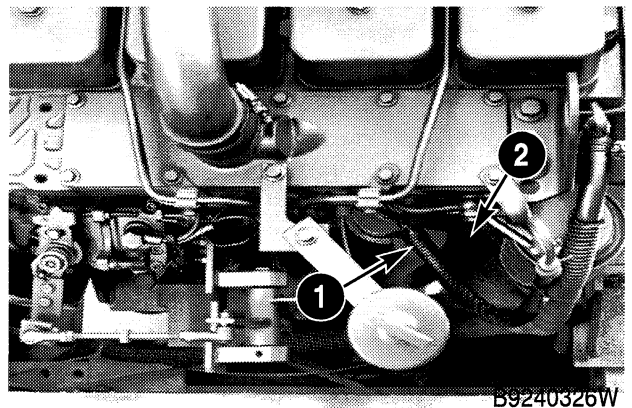

1. Supply Hose

2. Return Hose

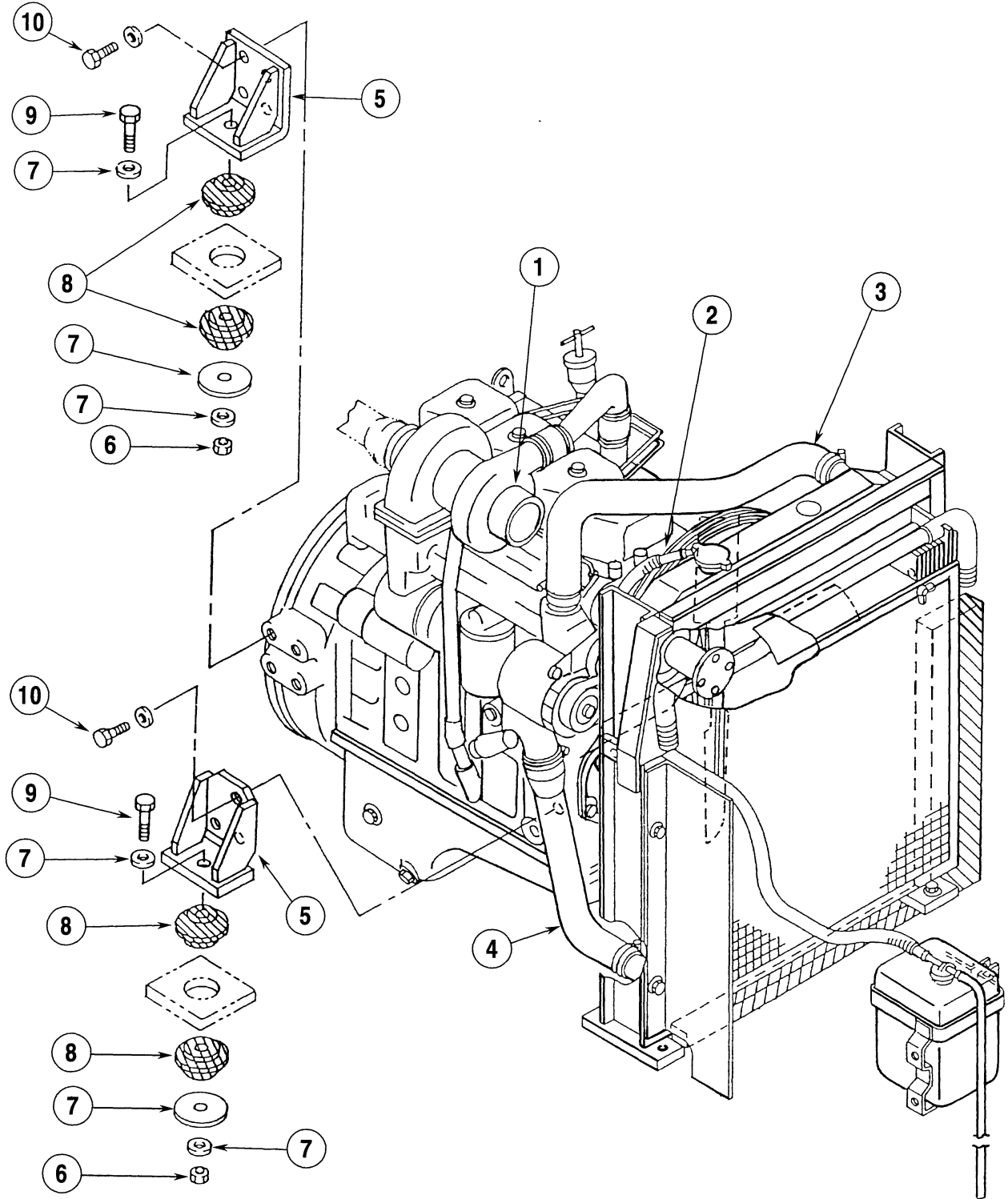

- 1. Disconnect Hose for Air Cleaner Here
- 2. Hose for the Coolant Reservoir
- 3. Top Radiator Hose
- 4. Bottom Radiator Hose
- 5. Engine Mounting Bracket

- 6. Self-Locking Nut
- 7. Washer
- 8. Insulator
- 9. Tighten to 195 to 231 pound-feet (264 to 313 Nm)
- 10. Tighten to 71 to 83 pound-feet (96 to 112 Nm)

B924479J

12. Disconnect the throttle cable from the bellcrank at the bracket on the engine. If the machine is equipped with ether start, disconnect the tube from the fitting in the intake manifold.

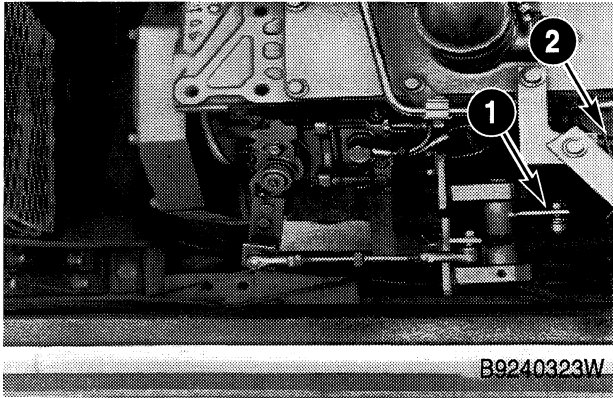

1. Disconnect Throttle Cable Here 2. Tube for Ether Start

13. Put identification tags on the wiring harness, wires and cables connected to the engine for correct assembly. Disconnect the wiring harness, wires and cables from the engine.
14. Disconnect the hoses for the heater from the engine. Install a plug in each hose.

15. Disconnect the ground strap from the engine.
16. Connect acceptable lifting equipment to the lifting eyes on the engine. The weight of the engine is 772 pounds (350 kg).
17. Connect a lifting sling to the hydraulic pump. The weight of the hydraulic pump is 201 pounds (91 kg). Remove the cap screws and hardened washers that hold the hydraulic pump to the flywheel housing.
18. Separate the hydraulic pump from the flywheel housing and disengage the splined shaft of the hydraulic pump from the splined hub in the coupling. The coupling and the drive plate will stay with the flywheel.
19. Remove the self-locking nuts (6), washers (7), insulators (8), and bolts (9) that hold the engine mounting brackets (5) to the frame.
20. Make sure that all hoses, tubes, cables, wires, and wiring harnesses are out of the way.
21. Lift the engine and remove the engine from the machine.

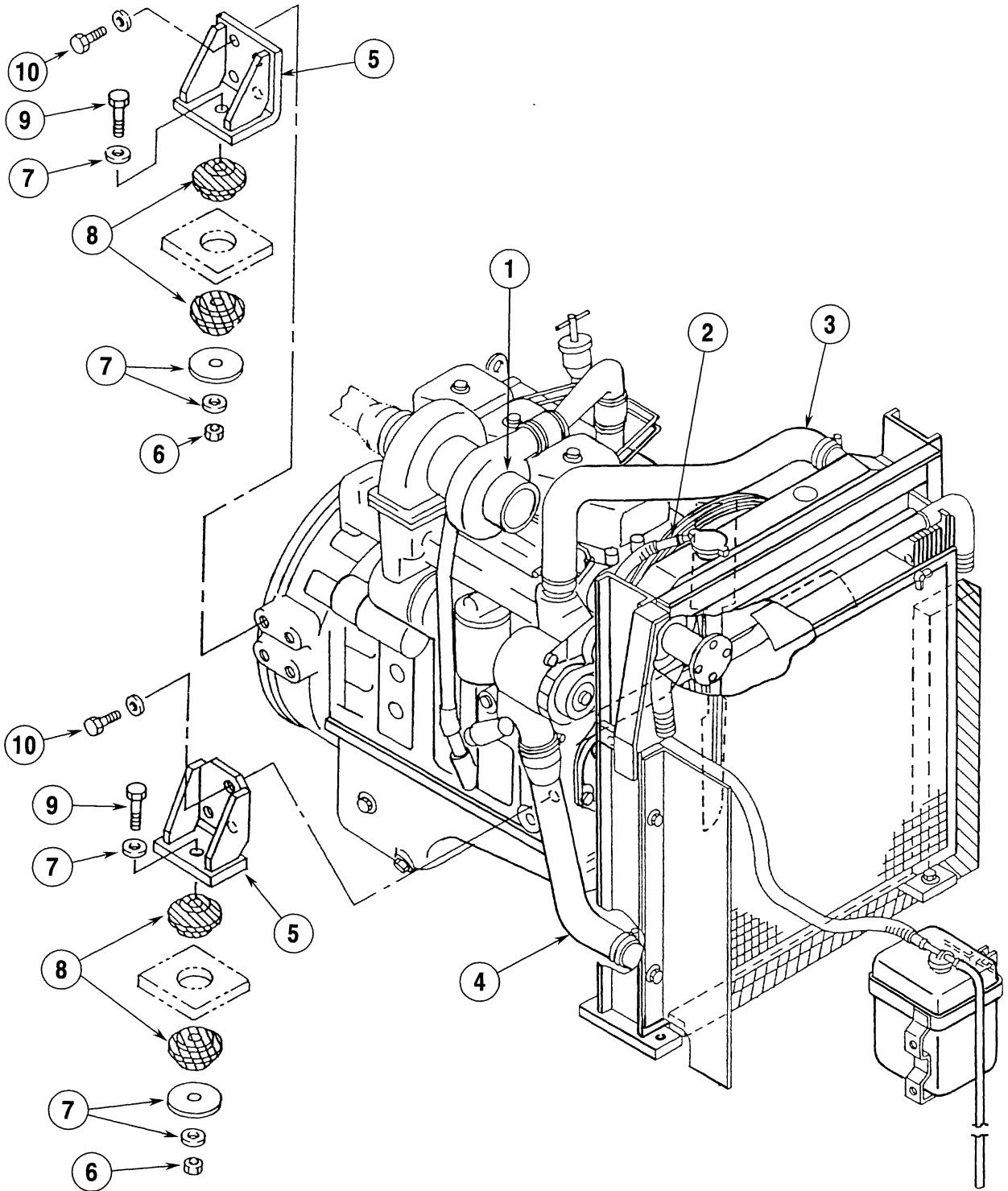

- 1. Disconnect Hose for Air Cleaner Here
- 2. Hose for the Coolant Reservoir
- 3. Top Radiator Hose
- 4. Bottom Radiator Hose
- 5. Engine Mounting Bracket

- 6. Self-Locking Nut
- 7. Washer
- 8. Insulator
- 9. Tighten to 195 to 231 pound-feet (264 to 313 Nm)
- 10. Tighten to 71 to 83 pound-feet (96 to 112 Nm)

B924479J

Installation

Installation is the reverse sequence of removal.

1. Check the condition of the insulators for the engine mounts. If the insulators are damaged, install new insulators.
2. Use the CAS-1690 tool to rotate the flywheel and align the splined hub in the coupling with the splined shaft of the hydraulic pump.
3. Tighten the bolts that hold the engine mounting brackets to the frame to the torque specifications shown on page 3.
4. Tighten the cap screws that hold the hydraulic pump to the flywheel housing to the torque specifications shown on page 3.
5. Tighten the cap screws that hold the fan and the spacer to the engine to the torque specifications shown on page 3.
6. Do the following procedure to bleed the air from the cooling system.
 - A. Close the drain valve on the radiator. Fill the radiator with coolant and fill the coolant reservoir to the fill neck. If new coolant is being installed, the coolant must be 55% ethylene glycol and 45% water.

B. Install and tighten the radiator cap.

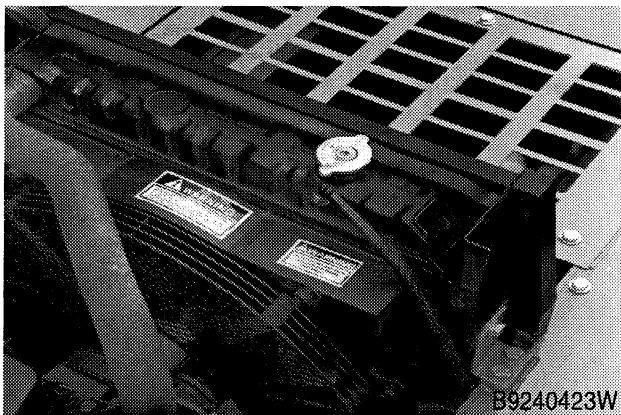

C. Install and tighten the cap for the coolant reservoir.

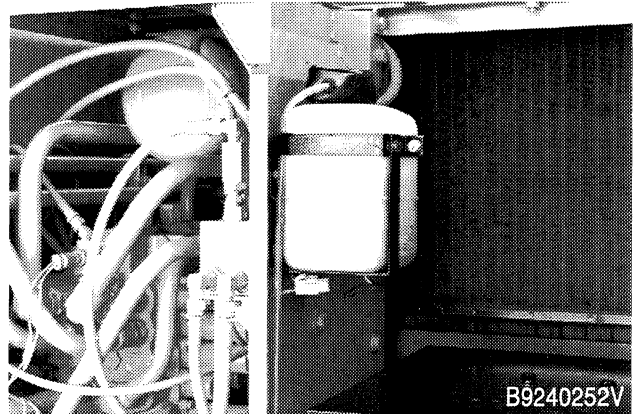

D. Close the shutoff valve for the heater at the top rear of the engine.

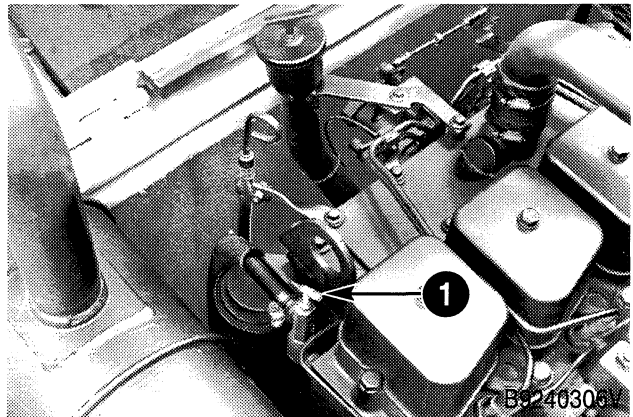

1. Shutoff Valve

- E. Start and run the engine at low idle for one minute.
- F. Stop the engine. Fill the radiator with coolant again and fill the coolant reservoir again.
- G. Cover the outside of the radiator core (the side away from the fan) with cardboard.
- H. Start and run the engine at high idle. Look at the water temperature gauge. When the water temperature gauge indicates normal operating temperature (4th or 5th amber bar illuminated), open the shutoff valve for the heater.
- I. Continue to run the engine until the last amber bar illuminates, then remove the cardboard from the radiator.

- J. Reduce the engine speed to low idle. Continue to run the engine at low idle for 30 seconds.
- K. Stop the engine and let the coolant cool.
- L. When the radiator feels COLD, remove the radiator cap and the cap for the coolant reservoir.

- M. Fill the radiator with coolant. Install and tighten the radiator cap.
- N. Fill the coolant reservoir with coolant to the FULL mark. Install the cap for the coolant reservoir.

Section 2002

2002

RADIATOR REMOVAL AND INSTALLATION

TABLE OF CONTENTS

SPECIFICATIONS	10
RADIATOR	10
Removal	10
Installation	11

NOTE: The J I Case Company reserves the right to make improvements in design or changes in specifications at any time without incurring any obligation to install them on units previously sold.

SPECIFICATIONS

Cooling System capacity 5 U.S. gallons (18.9 litres)

Special torques

 Cap screws that hold the fan and spacer to the engine 38 to 45 pound-feet (51 to 61 Nm)

Weight of the radiator 117 pounds (53 kg)